

TRAVEL
ADJUSTMENT
+/- 5° EACH
DIRECTION

AIR PORTS
1/4" NPT
(STAGGERED)

NAMUR VDI/VDE 3845
MOUNTING FOR
SOLENOID VALVE
10-24 UNC

TOP

BOTTOM

NOTES:

- 1) MAX ALLOWABLE OPERATING PRESSURE (MAOP) = 10 BAR (150 PSIG)
- 2) WARNING - SEE K-TORK INSTALLATION, OPERATION & MAINTENANCE MANUAL BEFORE MOUNTING, INSTALLING OR SERVICING.
- 3) SPECIFY SUPPLY AIR PRESSURE FOR SPRING-RETURN ACTUATORS.
- 4) ACTUATOR SHOWN IN FULL CW POSITION, SCRIBE ON SHAFT SHOWS VANE LOCATION POSITION (SPRING END / AIR START).
- 5) SPECIFY SPRING DIRECTION, CW STANDARD.
- 6) WEIGHT 6.01 kg (13.25 LB.)

(4 PLACES) ISO 5211
MOUNTING BASE F07, M8 x 1.25
TAPPED 16.0mm (.63in) DEEP,
70mm (2.76in) BOLT CIRCLE
STRADDLE \varnothing

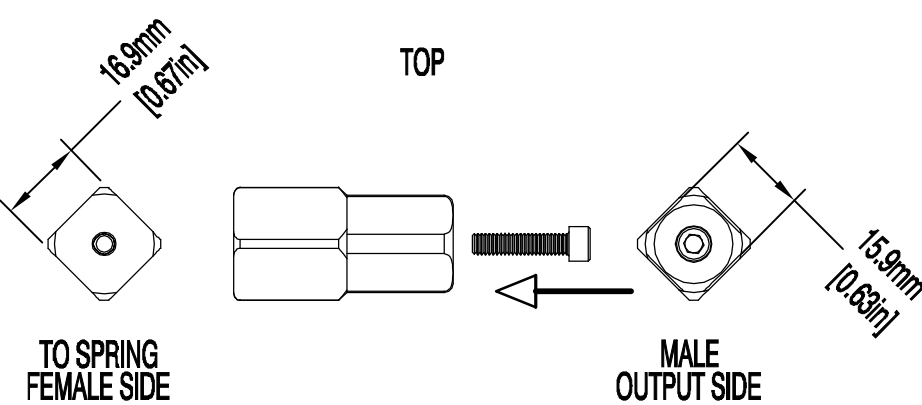
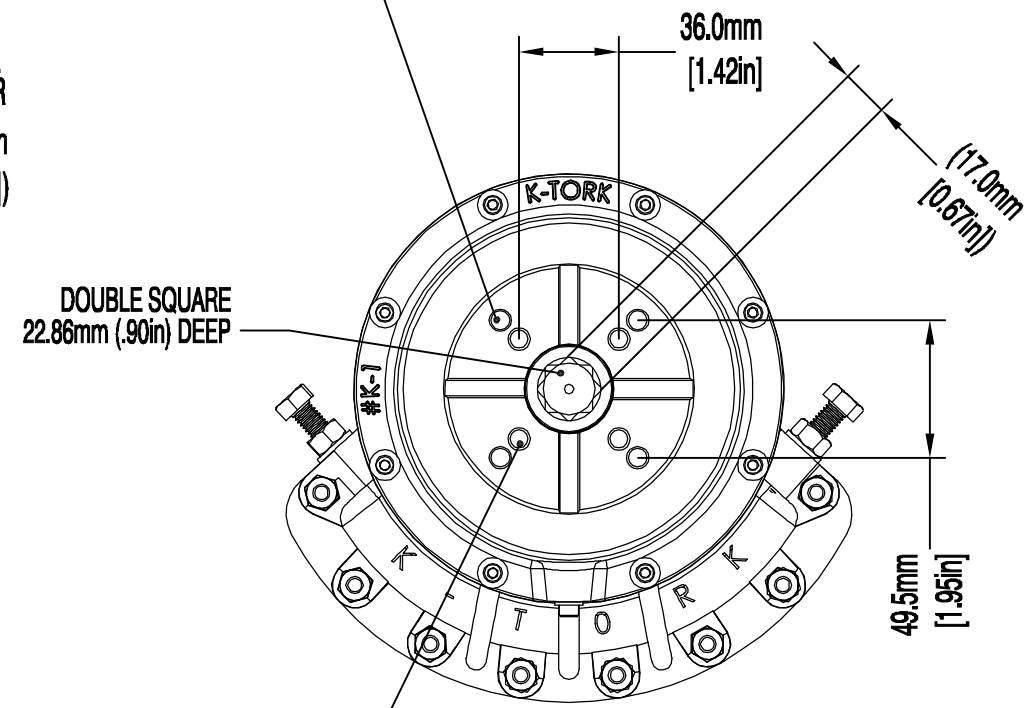
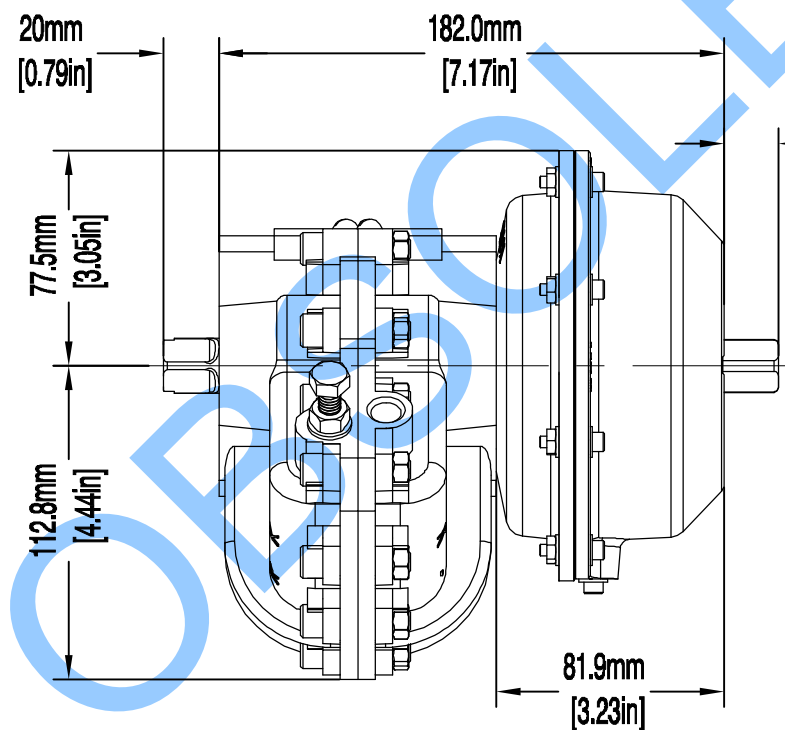
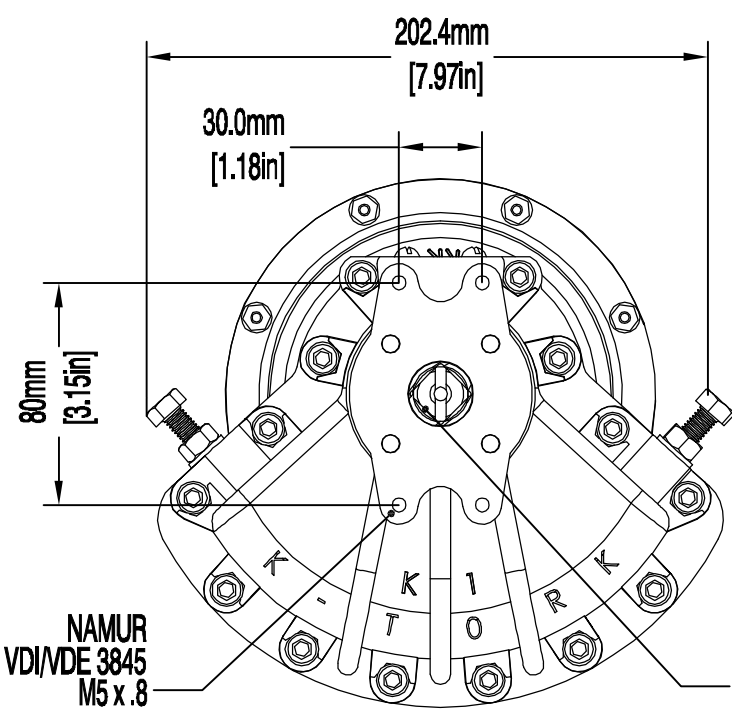

OPTIONAL MALE SHAFT ADAPTER KIT



This drawing is confidential and is the property of Rotork Dallas Inc. and must not be reproduced either wholly or partly. All rights in respect of patents, designs and copyrights are reserved. © 2015

Document type	DETAIL DRAWING	
	Dimensions in mm	
	Scale 1:1	
Created	S.DINESH	30-JAN-2015
Checked	S.SUDHIR	30-JAN-2015
Approved	K.PRICE	30-JAN-2015

Title		K-1 SPRING RETURN - MODEL IMPERIAL AIR PORTS & MOUNTING HOLES	
Drawing Number		D000000210	
Sheet	1	of	1
Size	A3		
Rev	0		

Rev B