

MOUNTING HOLES CAN BE POSITIONED ON CENTRES BY REMOVING 8 BOLTS INDICATED AND REPOSITIONING

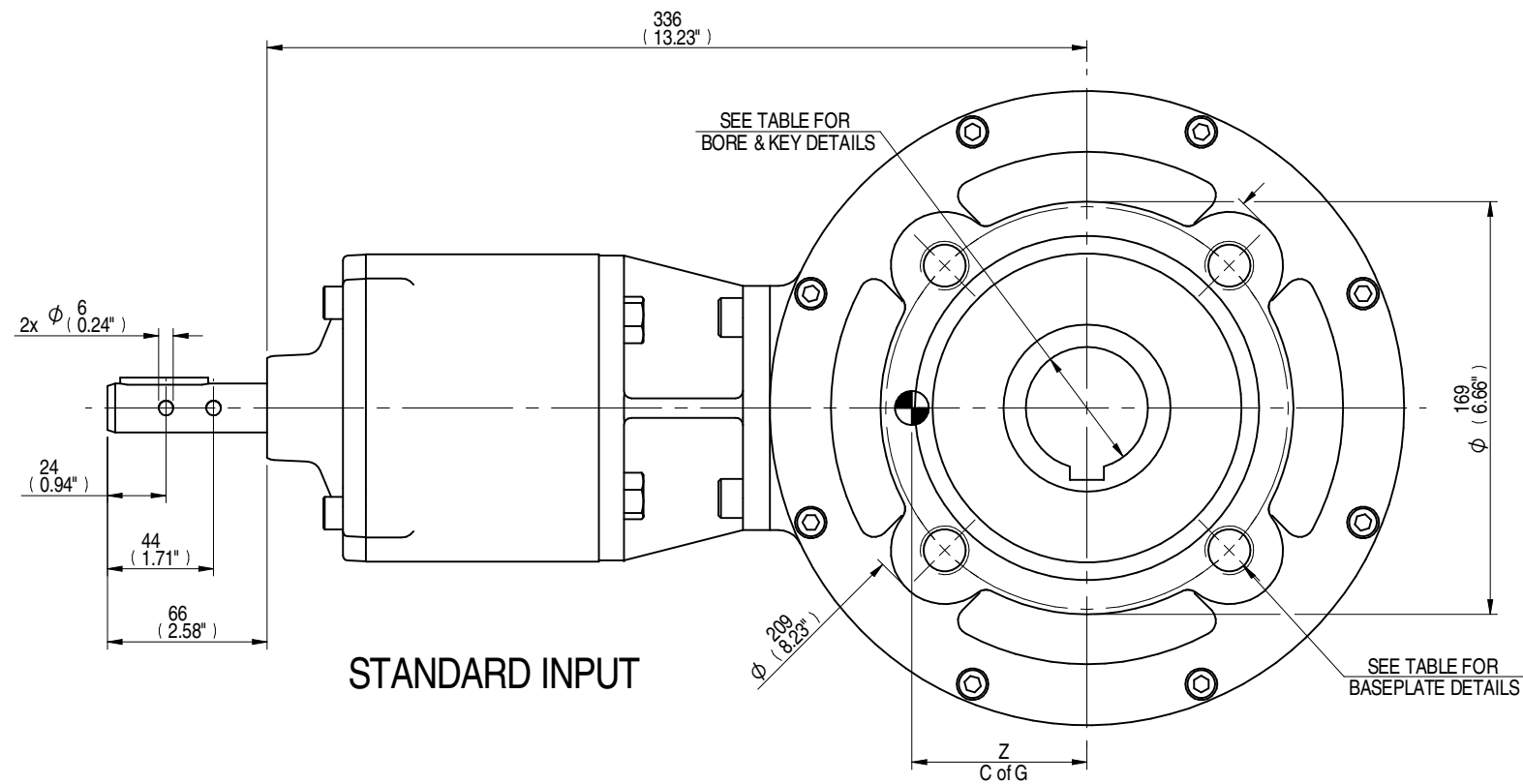
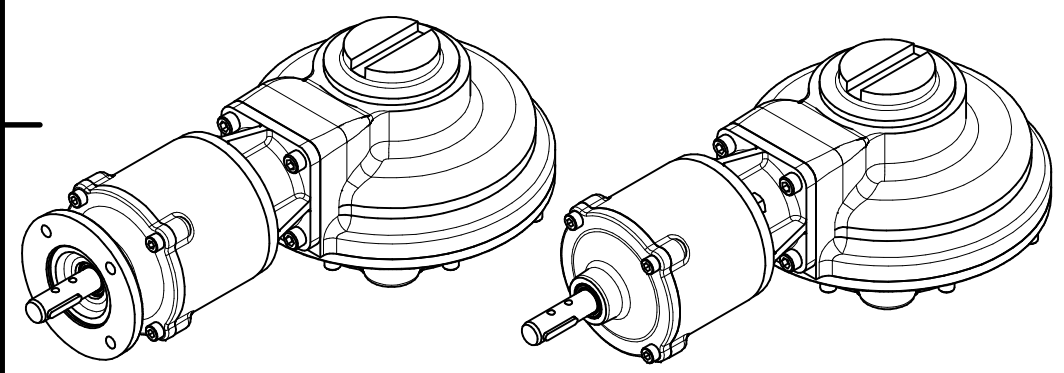
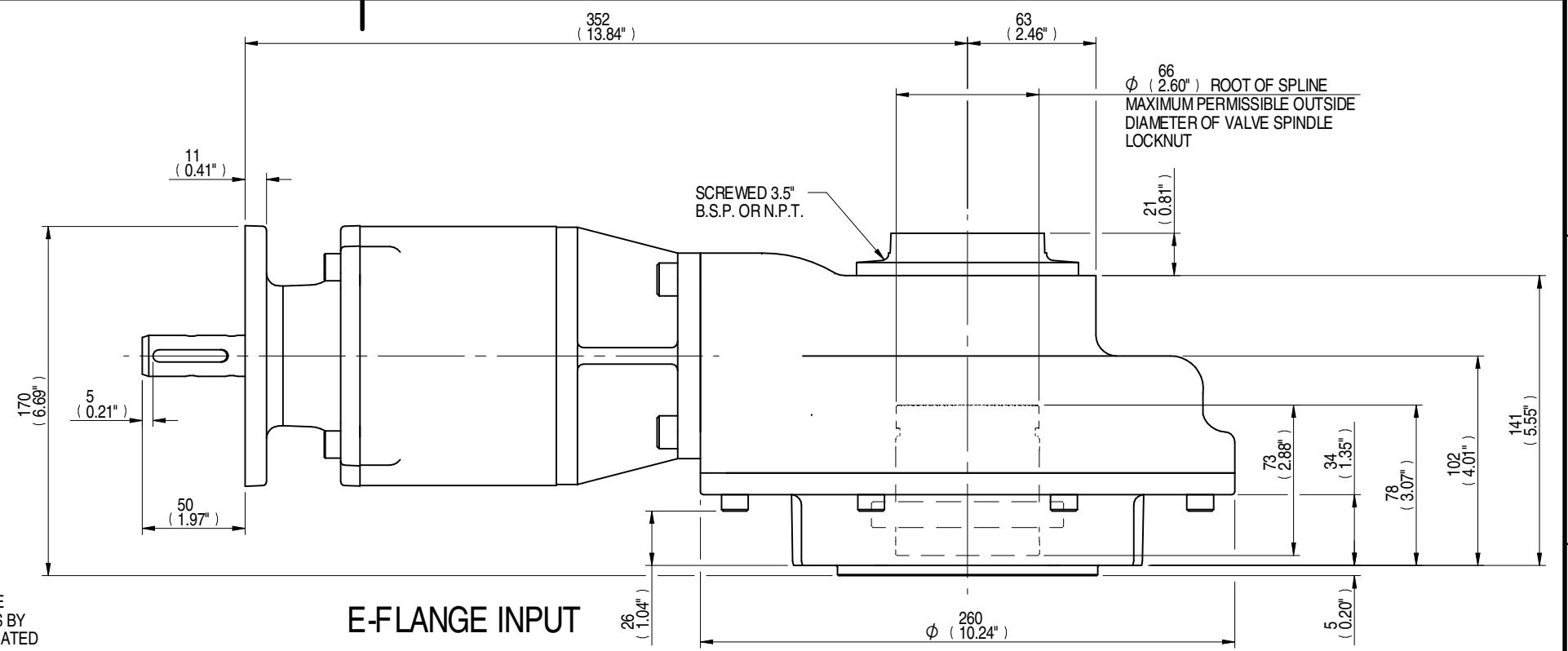

NOTE:
MPR IS NOT SUITABLE FOR MOTORISED APPLICATIONS.

| COMMON INPUT DETAILS | | E-FLANGE INPUT DETAILS | | | |
|----------------------|---------------------|------------------------|------------------|--------------|--------------------------------|
| SHAFT DIA. | KEY DETAILS | FLANGE O/DIA. | RECESS DIA. | RECESS DEPTH | HOLE DETAILS (45° OFF CENTRES) |
| Ø19.98-0.05 | 6x6x36 | Ø126 | Ø70.05+0.05 | 3 | 4 HOLES Ø10.5 ON Ø102.0 P.C. |
| (Ø0.787"-0.002") | (0.24"x0.24"x1.42") | (Ø4.96") | (Ø2.758"+0.002") | (0.12") | 4 HOLES Ø0.41" ON Ø4.02" P.C. |

| MOUNTING HOLES - BOLT CIRCLE (OFF CENTRES) | | |
|--|----------------------------------|--|
| STANDARD | SPIGOT DIAMETER | HOLE DETAILS (45° OFF CENTRES) |
| ISO F16 | Ø129.95-0.05 (Ø5.116"-0.002") | 4 HOLES M20X25 (0.98") DEEP ON Ø165.0 (Ø6.50") P.C. |
| FA16 | Ø126.87-0.25 (Ø4.995"-0.010") | 4 HOLES 3/4"UNCX25 (0.98") DEEP ON Ø165.1 (Ø6.50") P.C. |

| MAX BORE SQ KEY | | | MAX BORE RECTANGULAR KEY | | MAX. STEM SCREW ACCEPTANCE DIA. |
|-----------------|--------|---------|--------------------------|--------------|---------------------------------|
| STD | BORE | KEY | BORE | KEY | |
| BS4235 | - | - | 52.0 | 16x10 | 55 (2.125") |
| BS46 | 1.875" | 1/2" SQ | 2.000" | 1/2" x 5/16" | |
| ANSI B17.1 | 1.875" | 1/2" SQ | 2.000" | 1/2" x 3/8" | |

| DESCRIPTION | | TORQUE | | | C of G | | |
|-------------|-------|---------|-------|------|--------|----|----|
| MPR | RATIO | OUTPUT | INPUT | MA | X | Y | Z |
| MPR6 | 24:1 | 1700 Nm | 98 Nm | 17.3 | 0 | 28 | 78 |

AS PART OF CONTINUOUS PRODUCT DEVELOPMENT, ALL DETAILS SUBJECT TO CHANGE WITHOUT PRIOR NOTICE. FOR UP TO DATE DETAILS PLEASE VISIT www.rotork.com

| | | | | | |
|-----|----|---------|----------|------------|--------------------|
| Rev | CN | Revised | Approved | Date | Change Description |
| A | - | - | - | 22/04/2014 | FIRST ISSUE |

LEEDS - UK
www.rotork.com

This drawing is confidential and is the property of Rotork Gears and must not be reproduced either wholly or partly. All rights in respect of patents, designs and copyrights are reserved. © 2014

Document type **PUBLICITY** Mass 35.90 kg

Dimensions in mm
Scale 1:3

Created **J. DICKINSON** 22/04/2014
Checked **T. WITAMORE** 14/05/2014
Approved - -

Title
HOB6 GEARBOX
MPR6 MANUAL INPUT REDUCER F16/FA16 OUTPUT

Drawing Number
PUB-HOB6MPR6-F16

Rev **A**

Sheet 1 of 1 Size A3

Rev.01