

INPUT FLANGE DETAILS					
	FLANGE O/DIA. & THICKNESS	SHAFT DIA.	RECESS DIA.	HOLE DETAILS (45° OFF CENTRES)	KEY DETAILS
ISO F10	Ø125 (Ø4.92") x 10 (0.39")	Ø20.00 -0.05 (Ø0.787" -0.002")	Ø70.05 +0.05 (Ø2.758" +0.002")	4 HOLES Ø10.5 (Ø0.41") ON Ø102.0 (Ø4.02") P.C.	6x6x40 (0.24"x0.24"x1.57")
FA10	Ø125 (Ø4.92") x 10 (0.39")	Ø20.00 -0.05 (Ø0.787" -0.002")	Ø58.75 +0.05 (Ø2.313" +0.002")	4 HOLES Ø10.5 (Ø0.41") ON Ø102.0 (Ø4.02") P.C.	6x6x40 (0.24"x0.24"x1.57")
ISO F14	Ø175 (Ø6.89") x 15 (0.59")	Ø30.00 -0.05 (Ø1.181" -0.002")	Ø100.05 +0.05 (Ø3.939" +0.002")	4 HOLES Ø16.5 (Ø0.65") ON Ø140.0 (Ø5.51") P.C.	8x7x40 (0.31"x0.28"x1.57")
FA14	Ø175 (Ø6.89") x 15 (0.59")	Ø30.00 -0.05 (Ø1.181" -0.002")	Ø95.27 +0.05 (Ø3.751" +0.002")	4 HOLES Ø16.5 (Ø0.65") ON Ø140.0 (Ø5.51") P.C.	8x7x40 (0.31"x0.28"x1.57")

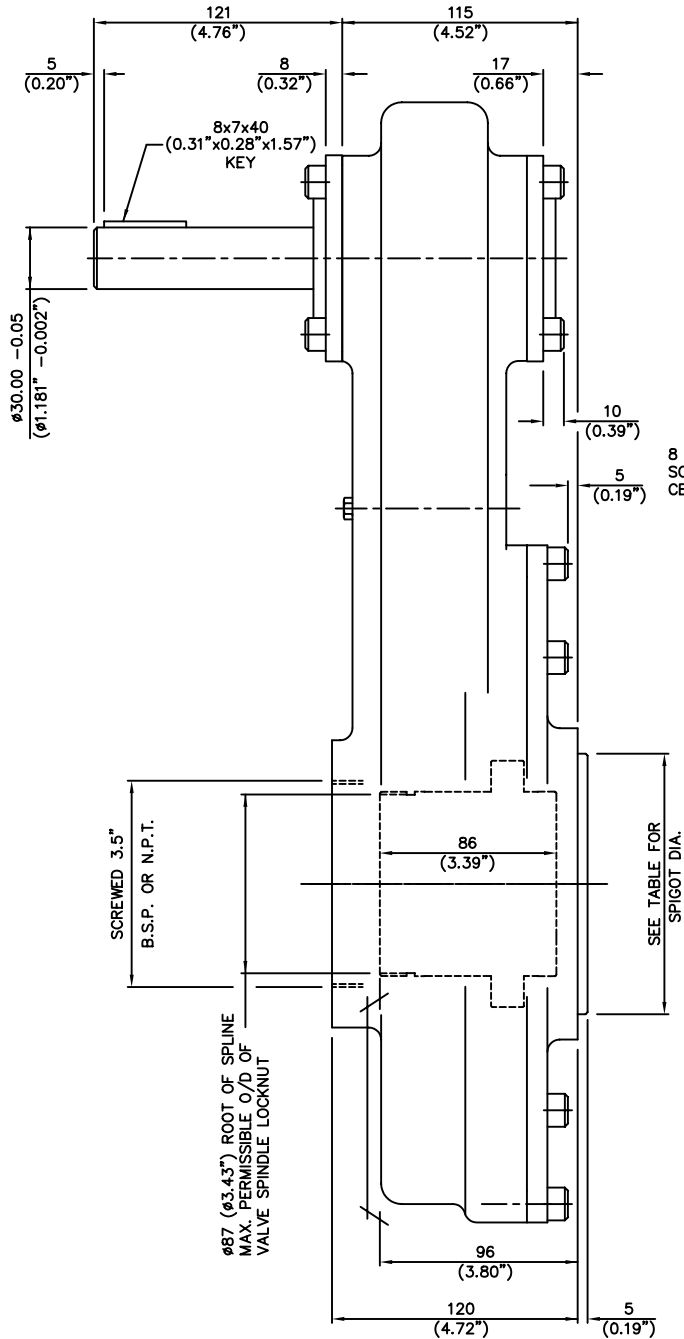

4 OFF M10 SCREWS (EACH SIDE)
ON Ø105 (Ø4.13") P.C.

8 OFF M10 BASEPLATE SECURING
SCREWS EQUALLY SPACED ON
CENTRES ON Ø312 (Ø12.28") P.C.

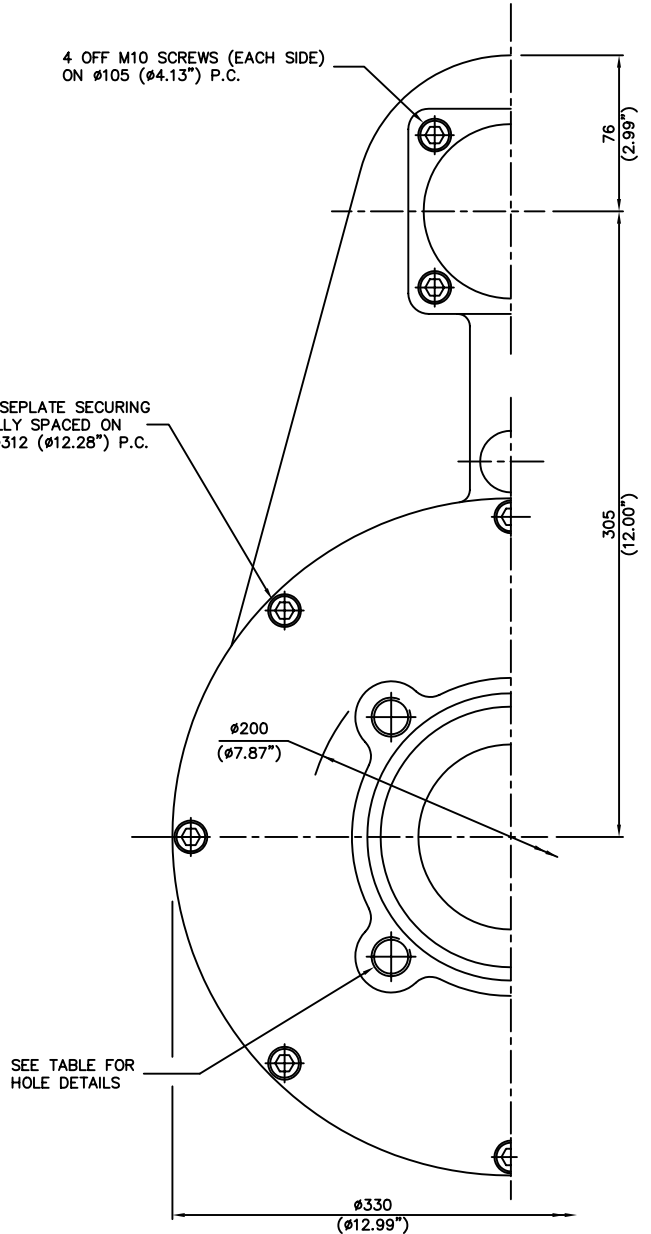

BASEPLATE DETAILS		
	SPIGOT DIA.	HOLE DETAILS (45° OFF CENTRES)
ISO F16	Ø129.95 -0.05 (Ø5.116" -0.002")	4 HOLES M20x25 (0.98") DEEP ON Ø165.0 (Ø6.50") P.C.
FA16	Ø126.87 -0.25 (Ø4.995" -0.010")	4 HOLES 3/4"UNCx25 (0.98") DEEP ON Ø165.0 (Ø6.50") P.C.

A	ORIGINAL ISSUE
ISSUE	ALTERATIONS

**rotork
gears**

NOMINAL RATIO	2:1	3:1	4:1	6:1	8:1
EXACT RATIO	2.00:1	3.00:1	4.00:1	6.00:1	8.00:1
FACTOR (MECH. ADVANTAGE)	1.80	2.70	3.60	5.40	7.20

EXECCO LTD © 1996

OUTLINE DETAILS OF IS7
ISO & USA STANDARD

DRAWN: -	S.W.	10.9.96	SCALE
CHECKED: -			1:1

PUB\IS7CD