

BASEPLATE DETAILS		
	SPIGOT DIA.	HOLE DETAILS (45° OFF CENTRES)
ISO F07	Ø54.95 -0.05 (Ø2.163" -0.002")	4 HOLES M8x15 (0.59") DEEP ON Ø70.0 (Ø2.76") P.C.
FA07	Ø54.95 -0.05 (Ø2.163" -0.002")	4 HOLES 5/16"UNCx15 (0.59") DEEP ON Ø69.9 (Ø2.75") P.C.
ISO F10	Ø69.95 -0.05 (Ø2.754" -0.002")	4 HOLES M10x15 (0.59") DEEP ON Ø102 (Ø4.02") P.C.
FA10	Ø58.70 -0.05 (Ø2.311" -0.002")	4 HOLES 3/8"UNCx15 (0.59") DEEP ON Ø101.6 (Ø4.00") P.C.

MOTORISED INPUT FLANGE DETAILS					
	FLANGE O/DIA. & THICKNESS	SHAFT DIA.	RECESS DIA.	HOLE DETAILS (OFF CENTRES)	KEY DETAILS
ISO F10	Ø125 (Ø4.92") x 10 (0.39")	Ø20.00 -0.05 (Ø0.787" -0.002")	Ø70.05 +0.05 (Ø2.758" +0.002")	4 HOLES Ø10.5 (Ø0.41") ON Ø102.0 (Ø4.02") P.C.	KEY 6x6x40 (0.24"x0.24"x1.57")
FA10	Ø125 (Ø4.92") x 10 (0.39")	Ø20.00 -0.05 (Ø0.787" -0.002")	Ø58.75 +0.05 (Ø2.313" +0.002")	4 HOLES Ø10.5 (Ø0.41") ON Ø102.0 (Ø4.02") P.C.	KEY 6x6x40 (0.24"x0.24"x1.57")
ISO F14	Ø175 (Ø6.89") x 15 (0.59")	Ø30.00 -0.05 (Ø1.181" -0.002")	Ø100.05 +0.05 (Ø3.939" +0.002")	4 HOLES Ø16.5 (Ø0.65") ON Ø140.0 (Ø5.51") P.C.	KEY 8x7x40 (0.31"x0.28"x1.57")
FA14	Ø175 (Ø6.89") x 15 (0.59")	Ø30.00 -0.05 (Ø1.181" -0.002")	Ø95.27 +0.05 (Ø3.751" +0.002")	4 HOLES Ø16.5 (Ø0.65") ON Ø140.0 (Ø5.51") P.C.	KEY 8x7x40 (0.31"x0.28"x1.57")

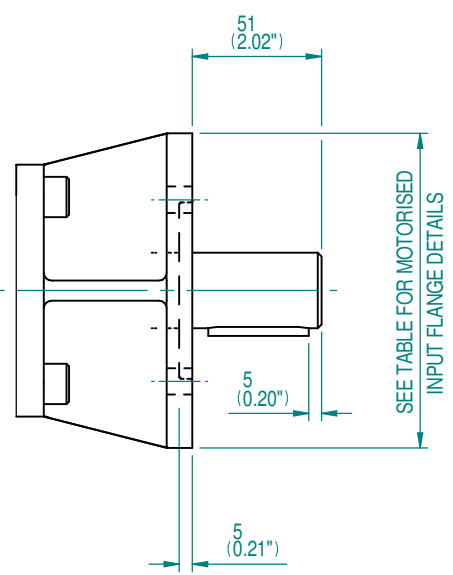

ROTORK GEARS
 REGINA HOUSE
 RING ROAD
 BRAMLEY
 LEEDS
 WEST YORKSHIRE

IB4 DUAL INPUTS AT 90° BEVEL GEARCASE

DETAILS SUBJECT TO CHANGE WITHOUT PRIOR NOTICE

FOR UP TO DATE DETAILS VISIT www.rotork.com

ISSUE :-	1	SCALE :-	1 : 3 (A4)
DATE :-		04/05/2010	
DRAWING No :-		PUB-IB4-DUAL90	